



This part should only be installed by personnel who have the necessary skill, training and tools to do the job correctly and safely. Incorrect installation can result in personal injury, vehicle damage and / or loss of vehicle control.

Read instructions completely before beginning installation.

Required Tools:

- Side cutters (or knife or scissors)

Installation Process:

The JounceShock Boot System installation is easiest to do when the JounceShock is out of the vehicle and on the bench. In some cases it may be possible to install the JounceShock Boot System onto a JounceShock while it is installed on the vehicle.

Any attached part such as a foot or extension shaft may need to be removed from the shaft end of the JounceShock prior to installing the JounceShock Boot System.

Refer to Figure 1.

1. Install the boot (#2) onto the JounceShock rod guide large end first. Pull the boot over the rod guide until it is slightly past the top of the lower groove. Install the cable tie (#1), line it up with the groove in the rod guide and pull tight. Cut off excess.

Note: If the JounceShock Boot System is installed with the JounceShock removed from the vehicle, the head of cable the tie may hit the mount when installing the JounceShock on the vehicle.

2. Pull the boot up slightly and install the collar (#3) onto JounceShock shaft end. The collar is split to ease installation. It should snap into the groove at the lower end of the shaft.
3. Pull the boot slightly past the groove in the collar. Install the cable tie (#1) over the groove and pull tight. Cut off excess.
4. Reinstall foot or extension on JounceShock shaft if removed.

JounceShock Adjustment with Boot System Installed:

The JounceShock adjusters can still be accessed when the JounceShock Boot System is installed by removing the cable tie (item #1) at the end of the JounceShock and sliding the boot off the collar. The collar has a cross drilled hole that allows a hex key tool to reach the adjusters in the end of the JounceShock. Simply rotate the collar until the hole lines up with the adjuster that you want to adjust. When finished, slide the boot into position and install a new cable tie.

Figure 1

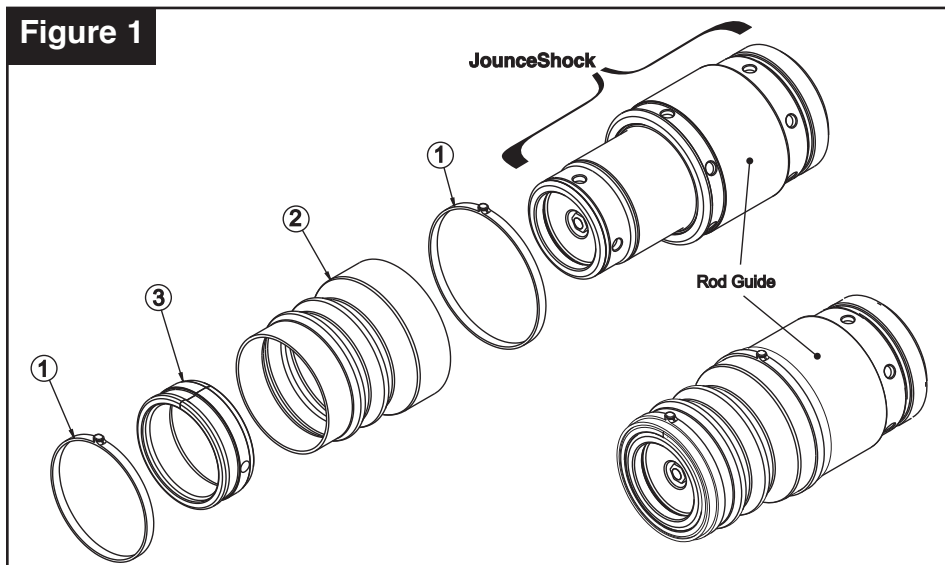

Parts List:

#	Description	Qty.
1	Cable Tie	2
2	Boot	1
3	Collar	1

There is no warranty stated or implied due to the inability to monitor the part's modification, installation, and use, except that Specialty Products Company warrants its products to be free from defects in material and workmanship for 90 days after purchase under normal use. In that case, parts returned must be determined by Specialty Products to be defective and Specialty Products's obligations under that warranty are solely limited to repairing or replacing, at its option, any part proven defective.

Final determination of the suitability of the parts for use contemplated by the buyer is the sole responsibility of the buyer. Specialty Products Company shall not be liable for any special, direct, indirect, incidental, or consequential damages that might be claimed as a result of the failure of any part, including claims for delay, loss of profits or labor. Specialty Products Company shall not be liable for any damage or injury to persons or property resulting from improper installation or misuse of any part subject to this warranty. There are no other warranties expressed or implied extending beyond those set forth above.



Specialty Products Company®

P.O. Box 923 • Longmont, CO 80502 • (303) 772-2103 • Fax: (303) 772-1918 • www.specprod.com • Email: info@specprod.com

Toll Free Technical Hot Line: 1-800-525-6505

©2014 Niwot Corp. dba Specialty Products Company® • Printed in U.S.A. • Form No. 98701 • Rev. 7/14